

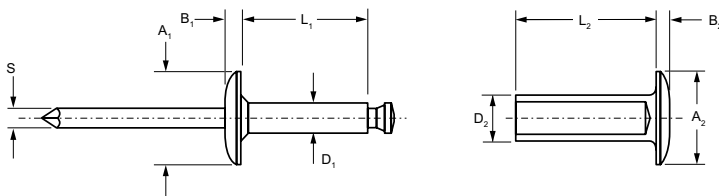

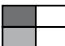

For installation information please refer to the tooling overview and manuals on our website.
 Pour les conditions de pose, merci de vous référer à la description de l'outil et aux manuels disponibles sur notre site Web.
 Angaben zur Verarbeitung entnehmen Sie bitte der Geräteübersicht und den Betriebsanleitungen auf unserer Website.
 Per informazioni sull'installazione preghiamo consultare i manuali e la panoramica degli attrezzi sul nostro sito web.
 Para ver información sobre máquinas de colocación, consulte nuestra página web, apartados visión general de máquinas y manuales.

English	Français	Deutsch	Italiano	Español
Body: Aluminium Clear alodine	Corps: Aluminium Passivation claire	Hülse: Aluminium Klar chromatiert	Corpo: Alluminio Passivato chiara	Cuerpo: Aluminio Pasivado claro
Mandrel: Steel Zinc plated	Tige: Acier Revêtement zingué	Dorn: Stahl Verzinkt	Gambo: Acciaio Zincati	Vástago: Acero Zincado
Tubular Component: Aluminium Clear alodine	Composant tubulaire: Aluminium Passivation claire	Röhrenförmiges Gegenstück: Aluminium Klar chromatiert	Componente tubulare: Alluminio Passivazione chiara	Componente tubular: Aluminio Pasivado claro



ø nom.			øD ₁	L ₁ max.	øA ₁	B ₁	øS	øD ₂	L ₂ max.	øA ₂	B ₂	 kN ¹⁾	Part No/ref
	min.	max.											
4.8 (3/16")	15.88	19.05	6.4	3.18	13.34	9.53	1.50	1.93	4.78	9.53	1.45	N/A	BSLMS-06BP-12
	17.48	22.23											BSLMS-06BP-14
	22.23	27.00											BSLMS-06BP-17
	27.00	31.75											BSLMS-06BP-20
	31.75	36.53											BSLMS-06BP-23
	36.53	41.28											BSLMS-06BP-26
	41.28	46.05											BSLMS-06BP-29
	46.05	50.80											BSLMS-06BP-32
	50.80	55.58											BSLMS-06BP-35
	55.58	60.33											BSLMS-06BP-38
6.4 (1/4")	15.88	19.05	7.9	4.75	11.23	15.88	2.41	2.90	6.35	15.88	2.41	2.0	BSLMS-08BP-12
	19.05	22.23			BSLMS-08BP-14								
	22.23	28.58			BSLMS-08BP-18								
	28.58	34.93			BSLMS-08BP-22								
	34.93	41.28			BSLMS-08BP-26								
	41.28	47.63			BSLMS-08BP-30								
	47.63	53.98			BSLMS-08BP-34								
	53.98	60.33			BSLMS-08BP-38								
	60.33	66.68			BSLMS-08BP-42								
	66.68	73.03			BSLMS-08BP-46								
	73.03	79.38			BSLMS-08BP-50								
	79.38	85.73			BSLMS-08BP-54								
	85.73	92.08			BSLMS-08BP-58								
	92.08	98.43			BSLMS-08BP-62								

all dimensions in mm / en millimètres / alle Maße in mm / in millimetri / en milímetros

1) typical values / valeurs moyennes / typische Werte / Valori tipici / valores típicos